



6/17 Bridge Street Epping NSW

1 1 1

Renovated Delight with Parking & Only 100 Metres to Rail/Shops.

Picture perfect one bedroom apartment in a brilliant boutique complex of only 12 units situated on the western side of Epping. It has been meticulously renovated to provide comfort & lifestyle and together with its full brick construction, it showcases immense quality. It's exclusively set in the heart of Epping for absolute convenience and the location does not get any better than this!

It poses as an ideal opportunity. The property is affordable and we encourage all interested parties to inspect & register their interest immediately.

With location one of its biggest assets, it is only a very short walk to Epping station, Coles supermarket, popular

Building Size : 46.5 sqm
View : <https://www.mypropertyepping.com.au/lease/nsw/northern-suburbs/epping/residential/unit/8013386>



George Horozakis
(02) 9868 4888



Peter Horozakis
(02) 9868 4888

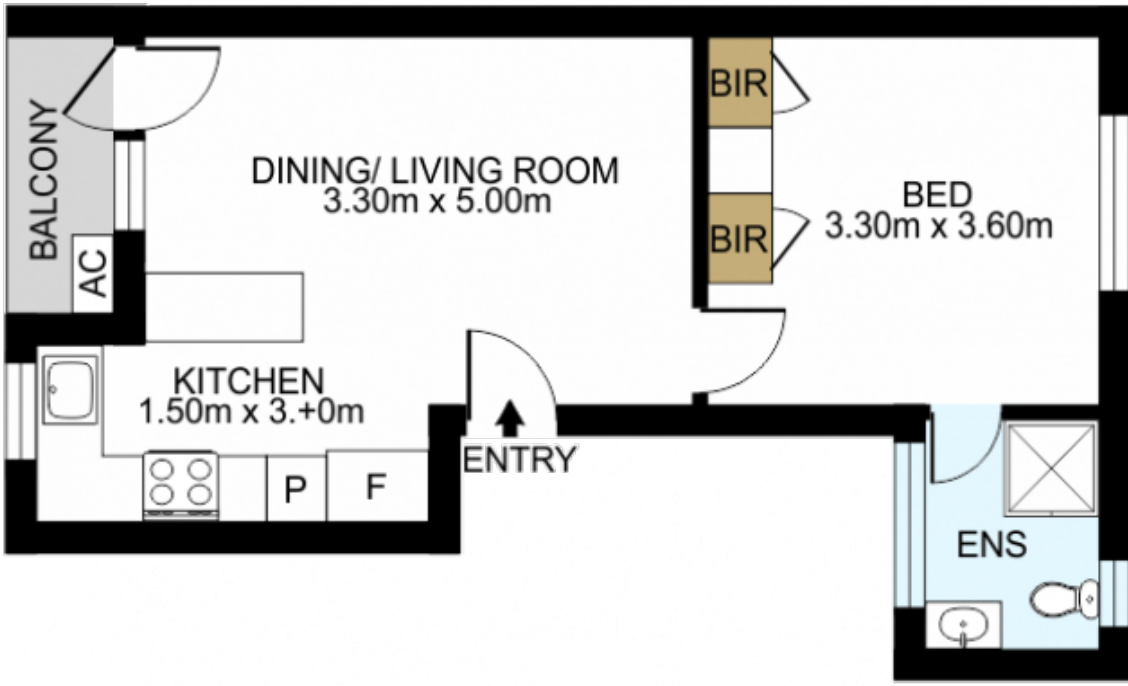

SHARED L'DRY



DISCLAIMER: THIS IS FOR ILLUSTRATIVE PURPOSES ONLY. ALL DIMENSIONS ARE APPROXIMATE AND IT DOES NOT CONSTITUTE PART OF ANY LEGAL DOCUMENTS.

ADDRESS:
6/17 Bridge St, Epping